



Continuous light element, yellow, 12-230 V AC/DC, 70 mm diameter, base BA 15d without light element

General technical data			
product brand name	SIRIUS		
product designation	Continuous light element		
design of the optical signal	continuous light		
type of voltage of the operating voltage	AC/DC		
operating voltage			
• at DC rated value	12 ... 230 V		
• at AC at 50 Hz rated value	12 ... 230 V		
• at AC at 60 Hz rated value	12 ... 230 V		
material	PC		
color	yellow		
fastening method	Bayonet		
reference code			
• acc. to DIN EN 61346-2	P		
• acc. to IEC 81346-2	P		
Mechanical data			
outer diameter of the signal column element	70 mm		
Lamp			
product component light source	No		
type of light source	filament lamp / LED		
light intensity	1.04 cd		
light intensity	0.79 ... 1.42 cd		
socket design	BA 15d		
Ambient conditions			
ambient temperature during operation	-20 ... +60 °C		
protection class IP	IP65		
height	65.5 mm		
width	70 mm		
Certificates/ approvals			
General Product Approval	EMC	Declaration of Conformity	other



[UK Declaration of Conformity](#)

[Confirmation](#)

### Further information

Information- and Downloadcenter (Catalogs, Brochures,...)

<https://www.siemens.com/ic10>

Industry Mall (Online ordering system)

<https://mall.industry.siemens.com/mall/en/en/Catalog/product?mlfb=8WD4400-1AD>

Cax online generator

<http://support.automation.siemens.com/WW/CAXorder/default.aspx?lang=en&mlfb=8WD4400-1AD>

Service&Support (Manuals, Certificates, Characteristics, FAQs,...)

<https://support.industry.siemens.com/cs/ww/en/ps/8WD4400-1AD>

Image database (product images, 2D dimension drawings, 3D models, device circuit diagrams, EPLAN macros, ...)

[http://www.automation.siemens.com/bilddb/cax\\_de.aspx?mlfb=8WD4400-1AD&lang=en](http://www.automation.siemens.com/bilddb/cax_de.aspx?mlfb=8WD4400-1AD&lang=en)

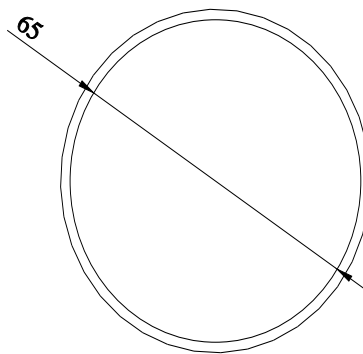
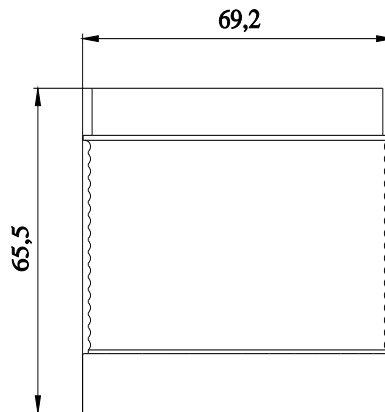

**-P**

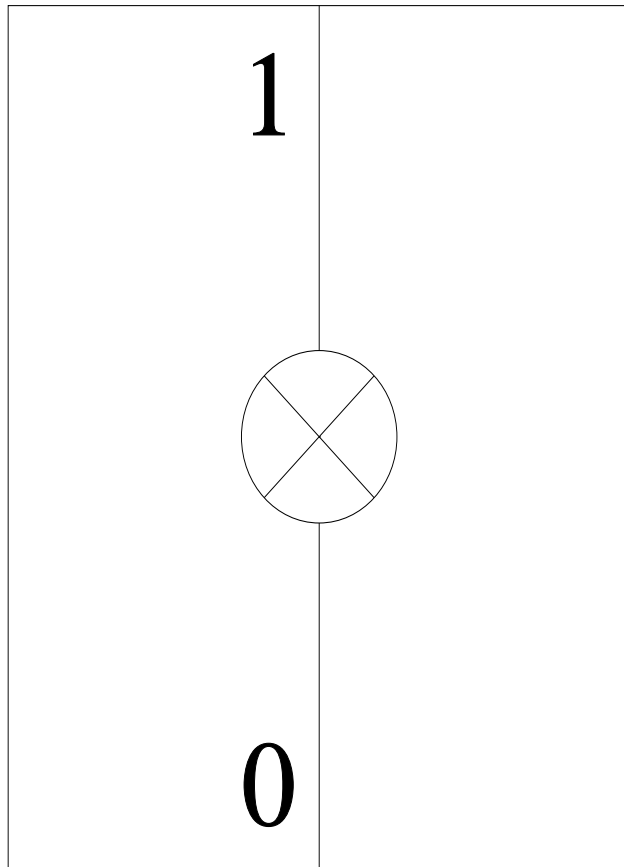

last modified:

2/25/2021 